

Military Silicon Power Rectifier

1N1202A-1N1206A, 1N3671A-1N3673A

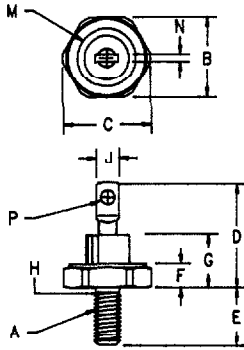

- Notes:**
- 10-32 UNF3A
 - Full threads within 2 1/2 threads
 - Standard Polarity: Stud is Cathode
Reverse Polarity: Stud is Anode

Dim.	Inches		Millimeter		Notes
	Minimum	Maximum	Minimum	Maximum	
A	---	---	---	---	1
B	.424	.437	10.77	11.10	
C	---	.505	---	12.82	
D	.600	.800	15.24	20.32	
E	.422	.453	10.72	11.50	
F	.075	.175	1.91	4.44	
G	---	.405	---	10.29	
H	.163	.189	4.15	4.80	2
J	.100	.140	2.54	3.56	
M	---	.350	---	8.89	Dia
N	.020	.065	.510	1.65	
P	.070	.100	1.78	2.54	Dia

D0203AA (D04)

Microsemi Catalog Number		Peak Reverse Voltage
Standard	Reverse	
1N1202A	1N1202RA	200V
1N1204A	1N1204RA	400V
1N1206A	1N1206RA	600V
1N3671A	1N3671RA	800V
1N3673A	1N3673RA	1000V

- Available in JAN, JANTX, JANTXV
- Mil-S-19500/260
- Glass Passivated Die
- Glass to metal construction
- 240 Amps surge rating
- V_{RRM} to 1000V

Electrical Characteristics		
Average forward current	$I_F(AV)$ 12 Amps	$T_C = 150^\circ C$, half sine wave, $R_{\theta JC} = 2.0^\circ C/W$
Maximum surge current	I_{FSM} 240 Amps	8.3ms, half sine, $T_J = 200^\circ C$
Max I^2t for fusing	I^2t 240 A ² s	
Max peak forward voltage	V_{FM} 1.35 Volts	$I_{FM} = 38A; 25^\circ C^*$
Max peak forward voltage	V_{FM} 2.30 Volts	$I_{FM} = 240A; 25^\circ C$
Max peak reverse current	I_{RM} 5 μA	$V_{RRM}, T_J = 25^\circ C$
Max peak reverse current	I_{RM} 1.0 mA	$V_{RRM}, T_J = 150^\circ C$
Max Recommended Operating Frequency	10 kHz	

*Pulse test: Pulse width 300 μ sec. Duty cycle 2%

Thermal and Mechanical Characteristics		
Storage temp range	T_{STG}	$-65^\circ C$ to $200^\circ C$
Operating junction temp range	T_J	$-65^\circ C$ to $200^\circ C$
Max thermal resistance	$R_{\theta JC}$	$2.0^\circ C/W$ Junction to Case
Typical thermal resistance	$R_{\theta JC}$	$1.0^\circ C/W$ Junction to Case
Max mounting torque		30 inch pounds maximum
Typical Weight		.16 ounces (5.0 grams) typical

Microsemi Corp.
Colorado

PH: 303-469-2161
FAX: 303 466 3776

E-1

1N1202A-1N1206A, 1N3671A-1N3673A

Figure 1
Typical Forward Characteristics

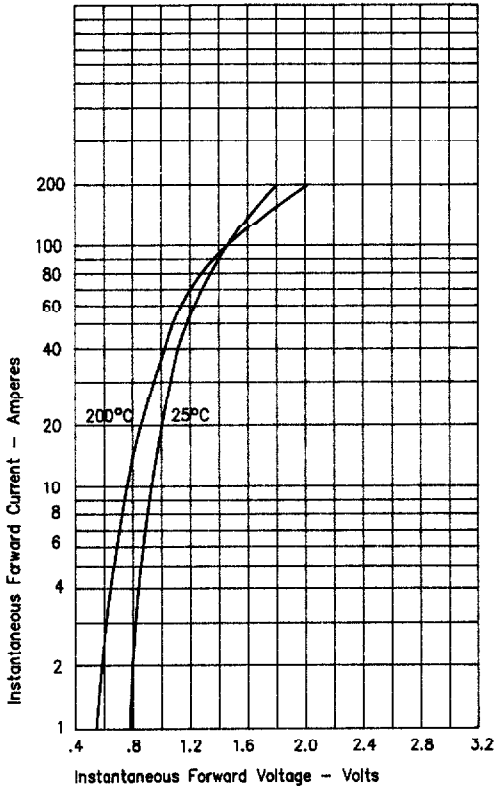

Figure 3
Forward Current Derating

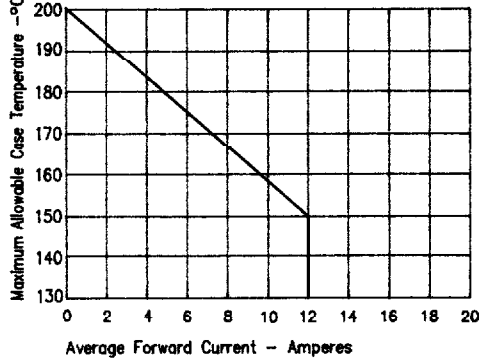

Figure 4
Transient Thermal Impedance

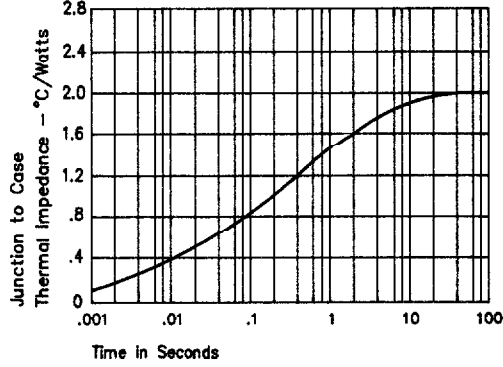

Figure 2
Typical Reverse Characteristics

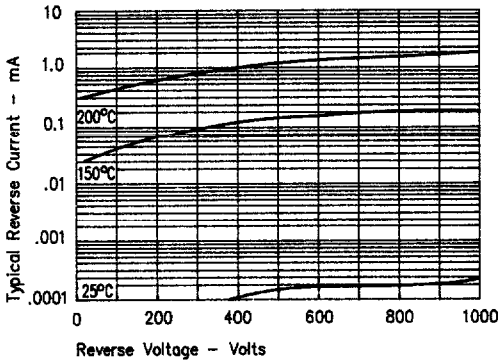

Figure 5
Maximum Nonrepetitive Surge Current

